

KEY PLAN  
NOT TO SCALE

SYMBOL LEGEND

- NEW LIGHT-DUTY BITUMINOUS PAVEMENT SEE DETAIL 1/C500
- NEW HEAVY-DUTY BITUMINOUS PAVEMENT SEE DETAIL 2/C500
- MATCH EXISTING BITUMINOUS PAVEMENT SECTION
- NEW LIGHT-DUTY CONCRETE PAVEMENT SEE DETAIL 3/C500
- NEW HEAVY-DUTY CONCRETE PAVEMENT SEE DETAIL 4/C500
- NEW STOOP/APRON SEE ARCHITECTURAL/STRUCTURAL
- NEW AG-LIME SURFACING SEE DETAIL 2/C503
- NEW VOLLEYBALL SAND SECTION SEE DETAIL 11/C502
- PAVEMENT MARKINGS

GENERAL

- PROPERTY LINE
- EASEMENT LINE
- RIGHT-OF-WAY LINE

KEY NOTES

- 1 LIGHT DUTY BITUMINOUS PAVEMENT, SEE DETAIL 1/C500
- 2 HEAVY-DUTY BITUMINOUS PAVEMENT, SEE DETAIL 2/C500
- 3 MATCH EXISTING BITUMINOUS PAVEMENT SECTION, ASSUME HEAVY-DUTY SECTION FOR BIDDING PURPOSE
- 4 LIGHT-DUTY CONCRETE PAVEMENT, SEE DETAIL 3/C500
- 5 HEAVY-DUTY CONCRETE PAVEMENT, SEE DETAIL 4/C500
- 6 B612 CONCRETE CURB AND GUTTER, SEE DETAIL 5/C500
- 7 SURMOUNTABLE CURB AND GUTTER, SEE DETAIL 6/C500
- 8 B618 CONCRETE CURB AND GUTTER, SEE DETAIL 7/C500
- 9 BOLLARD, SEE DETAIL 8/C500
- 10 PARKING SIGN AND POST, SEE DETAIL 9/C500
  - A. ADA PARKING STALL
  - B. STOP
  - C. DO NOT ENTER
  - D. DROP OFF LANE KEEP RIGHT
  - E. BUSES AND DELIVERY ONLY
  - F. ADA LOADING ZONE
- 11 ACCESSIBLE RAMP, SEE DETAIL 10/C500
  - A. TYPE 1
  - B. TYPE 2
- 12 FLAGPOLE, SEE DETAIL 11/C500
- 13 BASKETBALL GOAL, SEE DETAIL 13/C500
- 14 BASKETBALL COURT STRIPING, SEE DETAIL 12/C500
- 15 PARKING SIGN, POST, AND BOLLARD, SEE DETAIL 14/C500
  - A. ADA PARKING STALL
  - B. NO PARKING ACCESS AISLE
- 16 DISCUS EVENT, SEE DETAIL 1/C501
- 17 SHOT PUT EVENT, SEE DETAIL 2/C501
- 18 4' FENCING, SEE DETAIL 3/C501
- 19 MONUMENT SIGN, SEE ARCH/STR.
- 20 BIKE RACK, SEE SPECIFICATIONS
- 21 BENCH, SEE SPECIFICATIONS
- 22 GAS METER, SEE MECH.
- 23 LIGHT POLE, SEE ELEC.
- 24 INSTALL SALVAGED GOAL POST, SEE DETAIL 3/C503
- 25 TRANSITION CURB
- 26 BALL FIELD BACKSTOP, SEE DETAIL 1/C503
- 27 AG-LIME SURFACING, SEE DETAIL 2/C503
- 28 DISCUS EVENT WITH SALVAGED CAGE, SEE DETAIL 1/C501
- 29 FOUR SQUARE STRIPING 16'X16'
- 30 RESTORE EXISTING STRIPING
- 31 SAND VOLLEYBALL COURT, SEE DETAIL 11/C502
- 32 FURNISH AND INSTALL VOLLEYBALL STANDARDS AND NET, SEE SPECIFICATIONS
- 33 REINSTALL SALVAGED BALL FIELD BASES

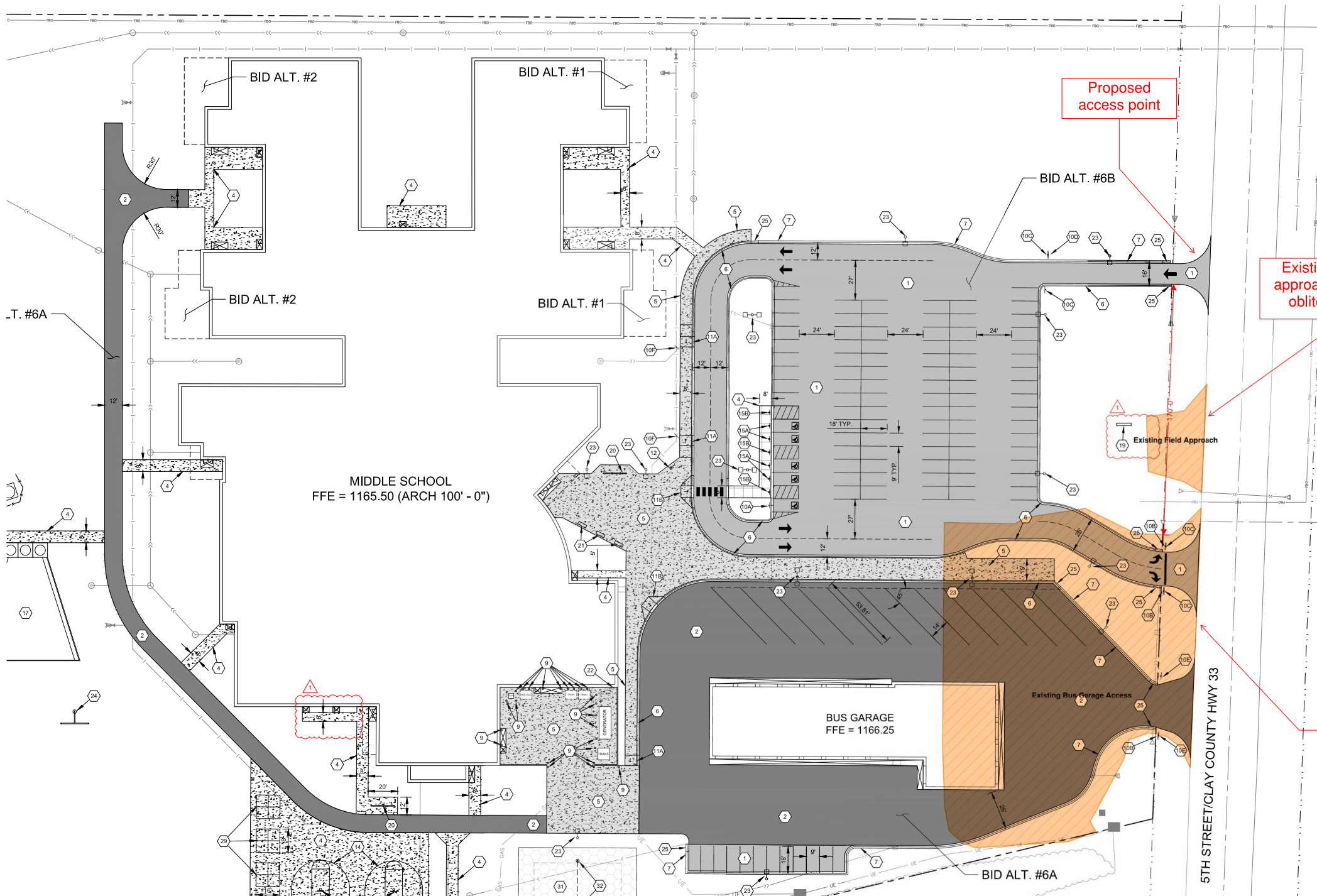

MIDDLE SCHOOL  
FFE = 1165.50 (ARCH 100' - 0")

BUS GARAGE  
FFE = 1166.25

BID ALT. #6A

5TH STREET/CLAY COUNTY HWY 33

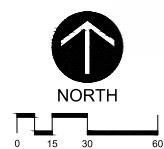

**Larson Engineering, Inc.**  
3524 Labore Road  
White Bear Lake, MN 55110  
651.481.9120 (f) 651.481.9201  
www.larsonengr.com

© 2024 Larson Engineering, Inc. All rights reserved.

CONSTRUCTION DOCUMENTS

REVISION SCHEDULE

NUMBER	DESCRIPTION	DATE
1	ADDENDUM #1	02/12/24

I hereby certify that this plan, specifications or report was prepared by me or under my direct supervision and that I am a duly licensed Professional Engineer under the laws of the state of Minnesota.

Print Name: Justin Nielson, P.E.  
Signature:   
Date: 02/01/2024 Registration No. 52487



**HAWLEY PUBLIC SCHOOLS MIDDLE SCHOOL**

PAVING & DIMENSION PLAN

Project No.: 12226178  
Date: 02/01/2024

**C201**