















ESTIMATED GRADING QUANTITIES		
ITEM	QUANTITY	UNIT
6" TOPSOIL STRIPPING	4,429	CY
15" TOPSOIL SPREADING	4,400	CY
COMMON EXCAVATION	1,364	CY
IMPORT	10,515	CY
SUBGRADE PREPARATION/GEOTEXTILE FABRIC	9,736	SY
AGGREGATE BASE & SURFACING	2,092	CY

- NOTES:
- 6" OF TOPSOIL STRIPPING WAS ASSUMED TO ALLOW FOR CLEARING OF ALL VEGETATION FROM THE SITE.
  - 15" OF TOPSOIL SPREADING WAS ASSUMED IN ALL PROPOSED SEEDED AREAS.
  - CUT/FILL WITHIN THE BUILDING FOOTPRINT(S) WAS CALCULATED TO 1' BELOW FFE. SEE STRUCTURAL AND ARCHITECTURAL FOR FILL REQUIREMENTS.
  - COMMON EXCAVATION AND IMPORT QUANTITIES ASSUME A FILL FACTOR OF 1.3.
  - NO COMPACTION WAS ASSUMED IN THE QUANTITY FOR AGGREGATE BASE.
  - GEOTEXTILE FABRIC PANELS SHALL BE A MINIMUM OF 12' WIDE AND INSTALLED WITH A MINIMUM OVERLAP OF 18" WITH JOINTS ORIENTATED TO FOLLOW TRAFFIC MOVEMENT.
  - GEOTEXTILE FABRIC QUANTITY DOES NOT INCLUDE REQUIRED OVERLAP.

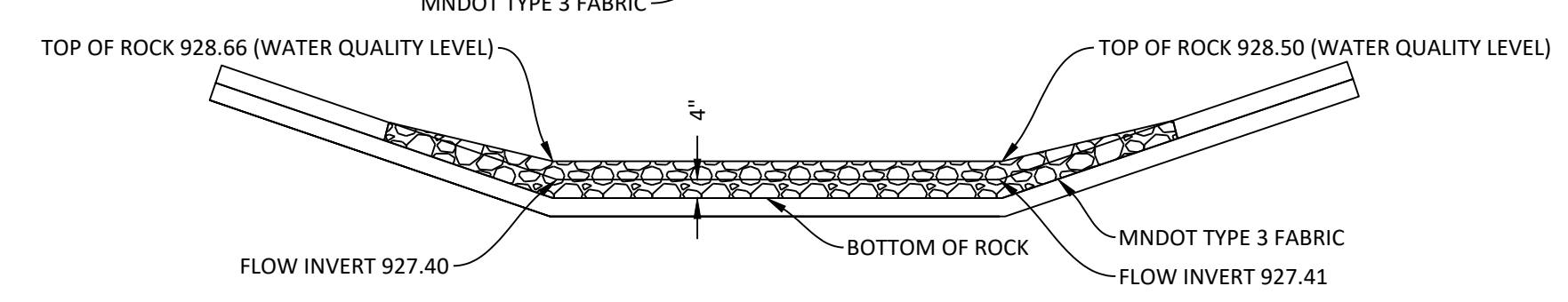
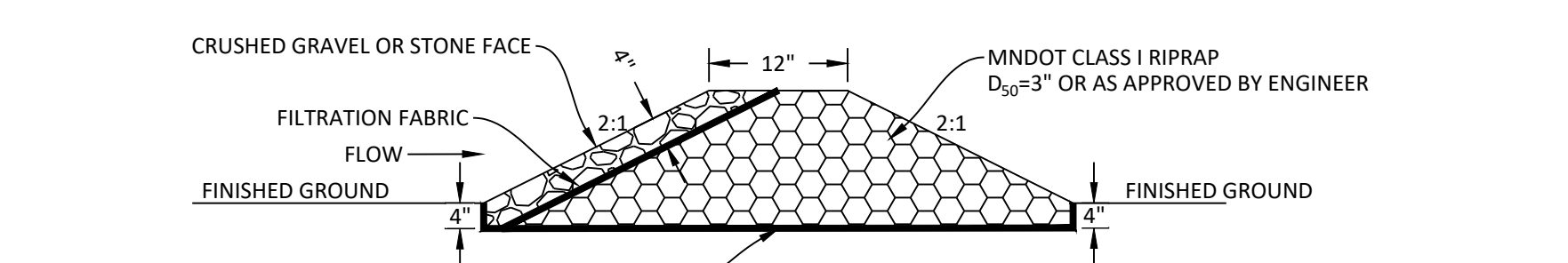
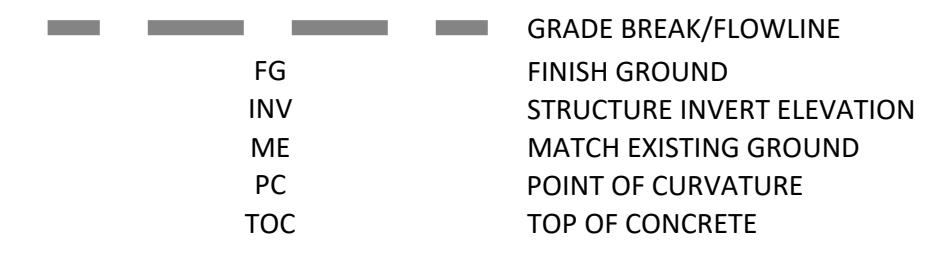

- NOTES:
- CRUSHED GRAVEL OR STONE FACE SHALL HAVE THE FOLLOWING GRADATION:  
100% PASSING 1 1/2 IN  
90-100% PASSING 1 IN  
0-15% PASSING 3/4 IN  
0-1% PASSING #200  
OR APPROVED EQUAL BY ENGINEER.

**A** ROCK CHECK DAM  
N.T.S.

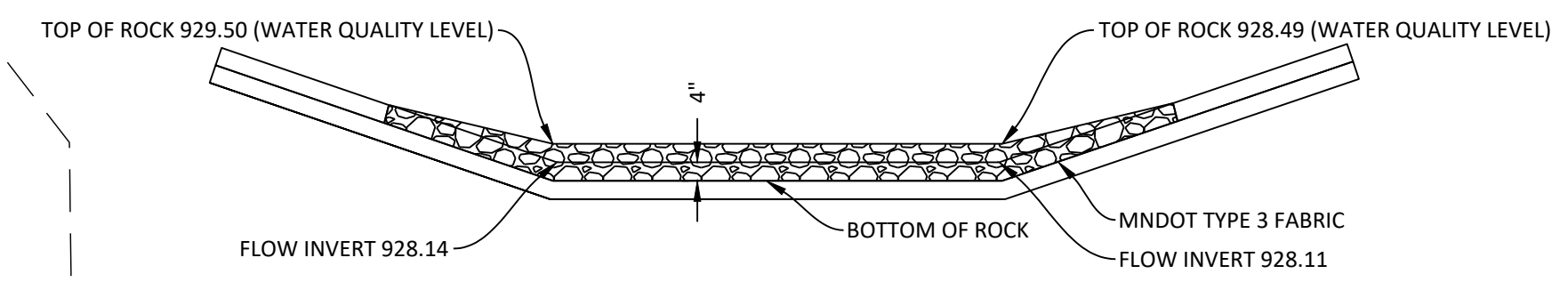
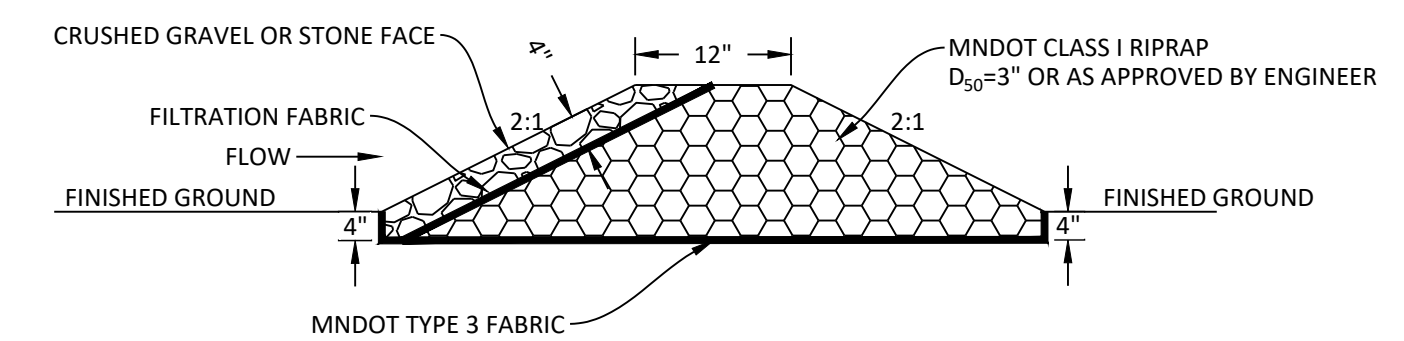

- NOTES:
- CRUSHED GRAVEL OR STONE FACE SHALL HAVE THE FOLLOWING GRADATION:  
100% PASSING 1 1/2 IN  
90-100% PASSING 1 IN  
0-15% PASSING 3/4 IN  
0-1% PASSING #200  
OR APPROVED EQUAL BY ENGINEER.

**B** ROCK CHECK DAM  
N.T.S.

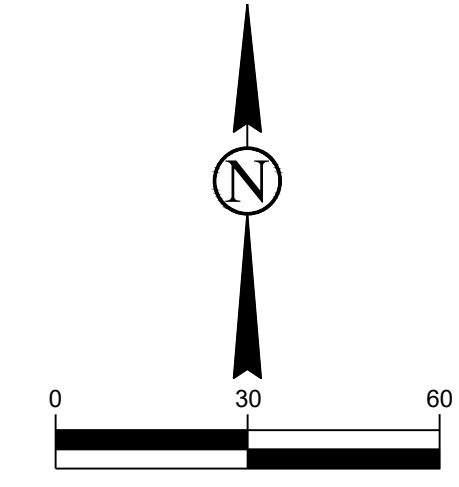

CALL BEFORE YOU DIG  
MINNESOTA  
UTILITIES UNDERGROUND LOCATION SERVICE  
1-800-252-1166

REVISIONS

STORAGE FACILITY  
CLAY COUNTY, MN

I HEREBY CERTIFY THAT THIS PLAN, SPECIFICATION, OR REPORT WAS PREPARED BY ME OR UNDER MY DIRECT SUPERVISION AND THAT I AM A DULY LICENSED PROFESSIONAL ENGINEER UNDER THE LAWS OF THE STATE OF MINNESOTA.

*Daniel C. Houts*  
DANIEL C. HOUTS  
DATE: 10/22/2024  
LICENSE # 56061

LE JOB #	24060
PROJECT DATE:	10/22/2024
CHECKED BY:	DJH
DRAWN BY:	TWT
APPROVED BY:	DJH

GRADING PLAN

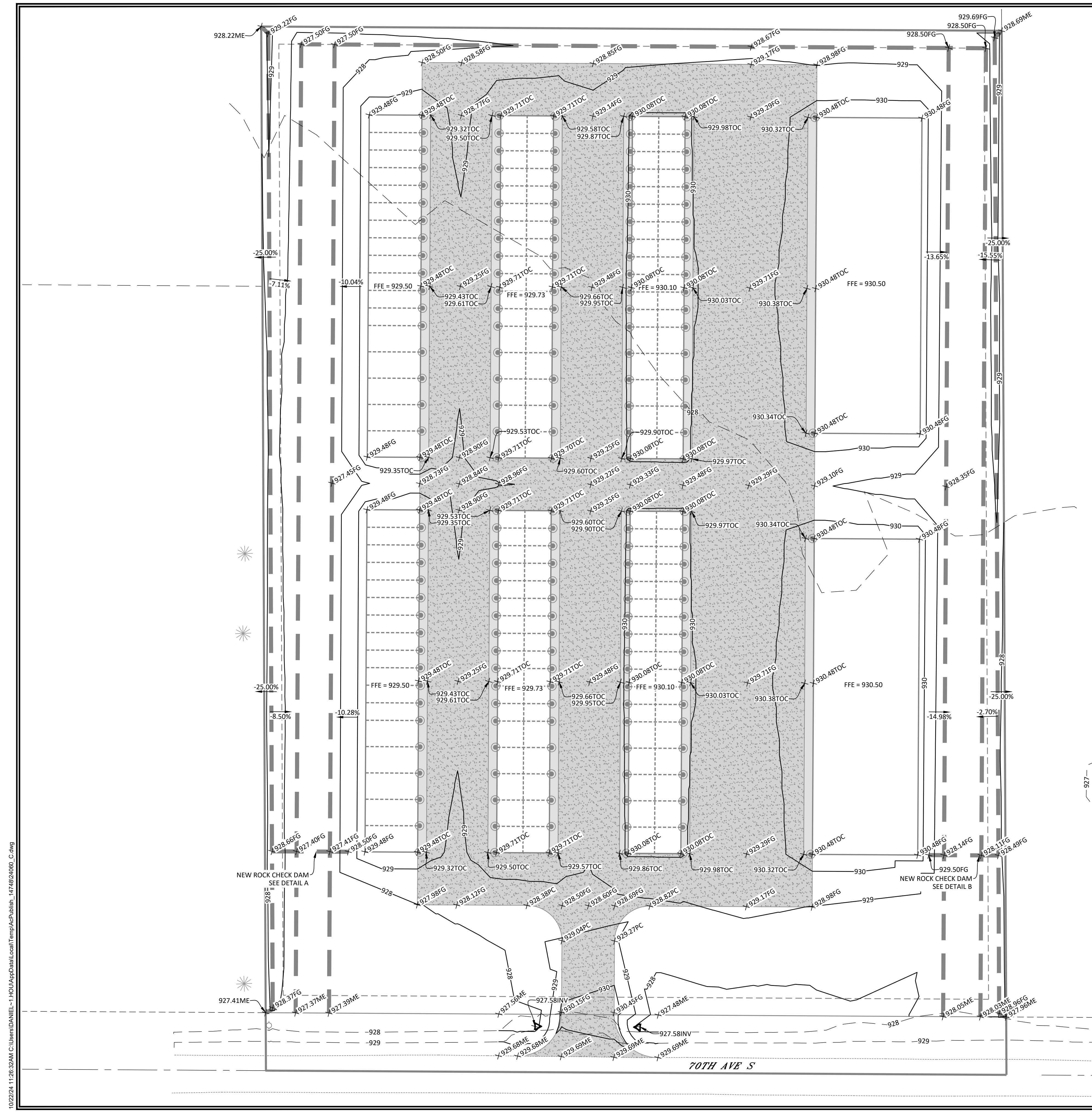

**C-5**

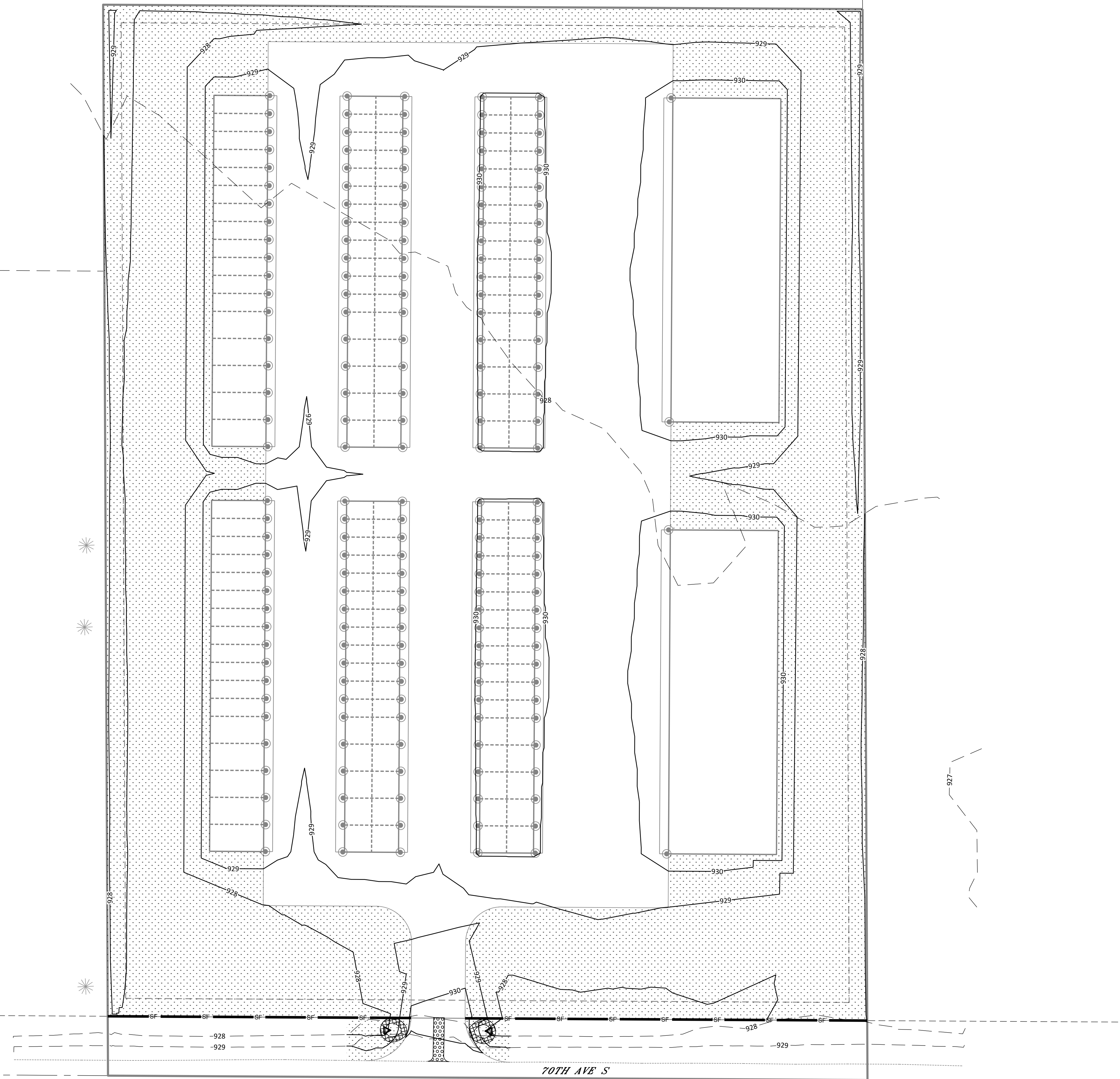

10/22/24 11:26:32AM C:\Users\DANIEL-1\OneDrive\OneDrive\Temp\Drawings\1474824060\_C.dwg

10/22/24 11:26:32AM C:\Users\ DANIEL-1\OneDrive\Desktop\Temp\AcPublish\47482460\_C.dwg

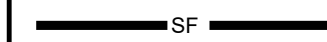

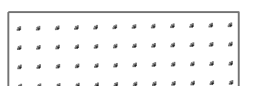
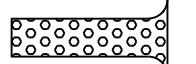
EROSION CONTROL LEGEND			
	SILT FENCE	392	LF
	FIBER ROLL PROTECTION (STRAW WATTLE)	54	LF
	SEEDING & HYDROMULCH	10,559	SY
	VEHICLE TRACKING PAD	1	EA

NOTES:

1. CONTRACTOR SHALL FOLLOW MPCA STORMWATER POLLUTION PREVENTION STANDARDS FOR ALL EROSION CONTROL DURING CONSTRUCTION.
2. CONTRACTOR SHALL INSTALL PERIMETER EROSION AND SEDIMENT CONTROLS PRIOR TO ANY LAND DISTURBING ACTIVITY.
3. IF CONCRETE WASHOUT WILL OCCUR ONSITE, CONTRACTOR SHALL COORDINATE LOCATION WITH OWNER.
4. CONTRACTOR SHALL LEAVE TEMPORARY EROSION AND SEDIMENT CONTROL MEASURES IN PLACE UNTIL ALL DISTURBED AREAS ARE PERMANENTLY STABILIZED.
5. CONTRACTOR IS RESPONSIBLE FOR ALL INSTALLATION, MAINTENANCE, REPLACEMENT IF NECESSARY, REMOVAL, ETC OF ANY AND ALL PROTECTION MEASURES NEEDED FROM THE START OF CONSTRUCTION UNTIL FINAL PERMANENT STABILIZATION IS ACHIEVED.
6. A FODS TRACKOUT CONTROL MAT MAY BE USED AS AN APPROVED EQUAL TO THE VEHICLE TRACKING PAD. CONTRACTOR SHALL SUBMIT PROPOSED MAT LAYOUT TO ENGINEER FOR REVIEW PRIOR TO INSTALLING.

REVISIONS

NO.	DATE	DESCRIPTION

STORAGE FACILITY  
CLAY COUNTY, MN

I HEREBY CERTIFY THAT THIS PLAN, SPECIFICATION, OR REPORT WAS PREPARED BY ME OR UNDER MY DIRECT SUPERVISION AND THAT I AM A DULY LICENSED PROFESSIONAL ENGINEER UNDER THE LAWS OF THE STATE OF MINNESOTA.

*Daniel Houts*  
 DANIEL HOUTS  
 DATE: 10/22/2024  
 LICENSE #: 56061

LE JOB #	24060
PROJECT DATE:	10/22/2024
CHECKED BY:	DJH
DRAWN BY:	TWT
APPROVED BY:	DJH

EROSION & SEDIMENT CONTROL PLAN

C-6

CALL BEFORE YOU DIG  
 MINNESOTA  
 UTILITIES UNDERGROUND LOCATION SERVICE  
 1-800-252-1166

